



# ILLUSTRATED PARTS BREAKDOWN

# B213A EXPANDER

## HOW TO USE THE IPB

### GENERAL

This IPB is compiled following the organization and nomenclature of the engineering drawing structure.

### MAJOR ASSEMBLY LOCATOR (When Applicable)

The Major Assembly Locator (first illustration) is an index that provides a description and a figure reference for all illustrations used in this manual.

### INDENTED PARTS LIST

This manual identifies each assembly being broken down (figure reference callout), and all parts of that assembly. Further breakdown of an assembly is shown by an asterisk (\*) preceding the item callouts in the Description Column. The number of asterisks preceding an item is used to denote the subordination of that item with respect to the Major Assembly. A single asterisk preceding an item description indicates that the item is part of the major assembly being illustrated. Items that are subordinate to single asterisks items, are denoted by two asterisks (\*\*) and immediately follow the related single asterisk item. This system of part identification provides a means for the user to identify the next higher assembly item and make alternate selections for parts when the required replacement part of assembly is not immediately available.

### COLUMN CALLOUT DESCRIPTION

Figure and Item - Indicates the figure number and item number of each part.

**Description** - Lists the name of the part and pertinent specifications (when required). Asterisks preceding the description denote the subordination of the part to the next higher assembly.

**DEC Part No.** - Lists the Digital part ordering number. A blank in this column indicates a Digital part number was not assigned at the time of publication.

**ECO Cut-In** - The notation at the top of this column indicates the ECO level of the system (option), at which the IPB was initially prepared. Subsequent ECO level designations, that modify existing parts or add new parts to the device, are inserted in the ECO Cut-In column next to the part that is added or modified.

**Used On Code** - Letters in this column correspond to the variation codes assigned in Figure 1. Parts with an Alpha notation(s) are used only in those option variations. A blank indicates that the part is used on all option variations.

**Ref Fig No.** - A cross reference between illustrations. For each Major Assembly, the number in this column denotes the figure of the next higher assembly. For all subassemblies, the number in this column denotes the figure showing additional detailed breakdown.

**PART NUMBER/PART DESCRIPTION INDEX SECTION**  
Parts are sorted both numerically and alphabetically by description, referenced to a location within the IPB, by figure number and item number.

REVISION HISTORY				OTHER IPB MANUALS REFERENCED
PRINTING	ECO LEVEL		DATE	
3rd Printing	B213A	00000-00001	24-AUG-89	EK-BA213-IP
	70-24227	00002-00008		
	70-24037	00001-00004		
	70-24041	00000-00000		
	70-24046	00001-00002		

Digital Equipment Corporation reserves the right, without notice, to make substitutions and modifications in the specifications of products documented in this manual and further reserves the right to withdraw any of these products from the market without notice.

Digital Equipment Corporation is not responsible for errors which may appear in the technical description (including illustrations and photographs) of the products covered by this manual.

None of the descriptions contained in this manual imply the granting of any license whatsoever to make, use or sell equipment constructed in accordance therewith.

Copyright © 1989, 1990 by Digital Equipment Corporation. All rights reserved.

The postage-paid READER'S COMMENTS form on the last page of this document requests your critical evaluation to assist us in preparing future documentation.

The following are trademarks of Digital Equipment Corporation :

---



DEC  
DECUS  
PDP  
UNIBUS  
VAX  
KDA50  
Mate-N-Lok  
MicroVAX  
Q-Bus  
RA70  
SDI

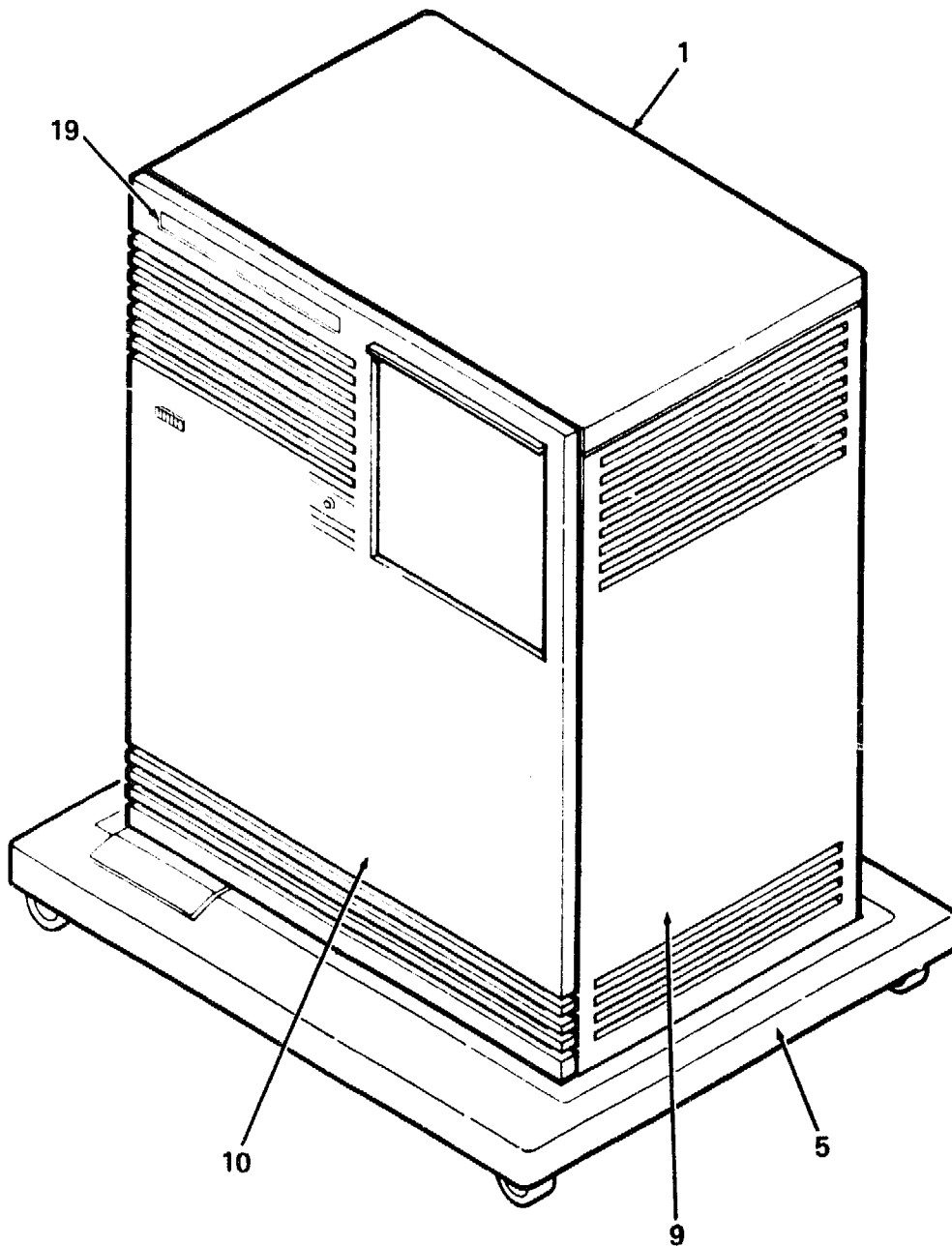

B213A-01-BD

**Figure 1. B213A Expander (Sheet 1 of 3)**



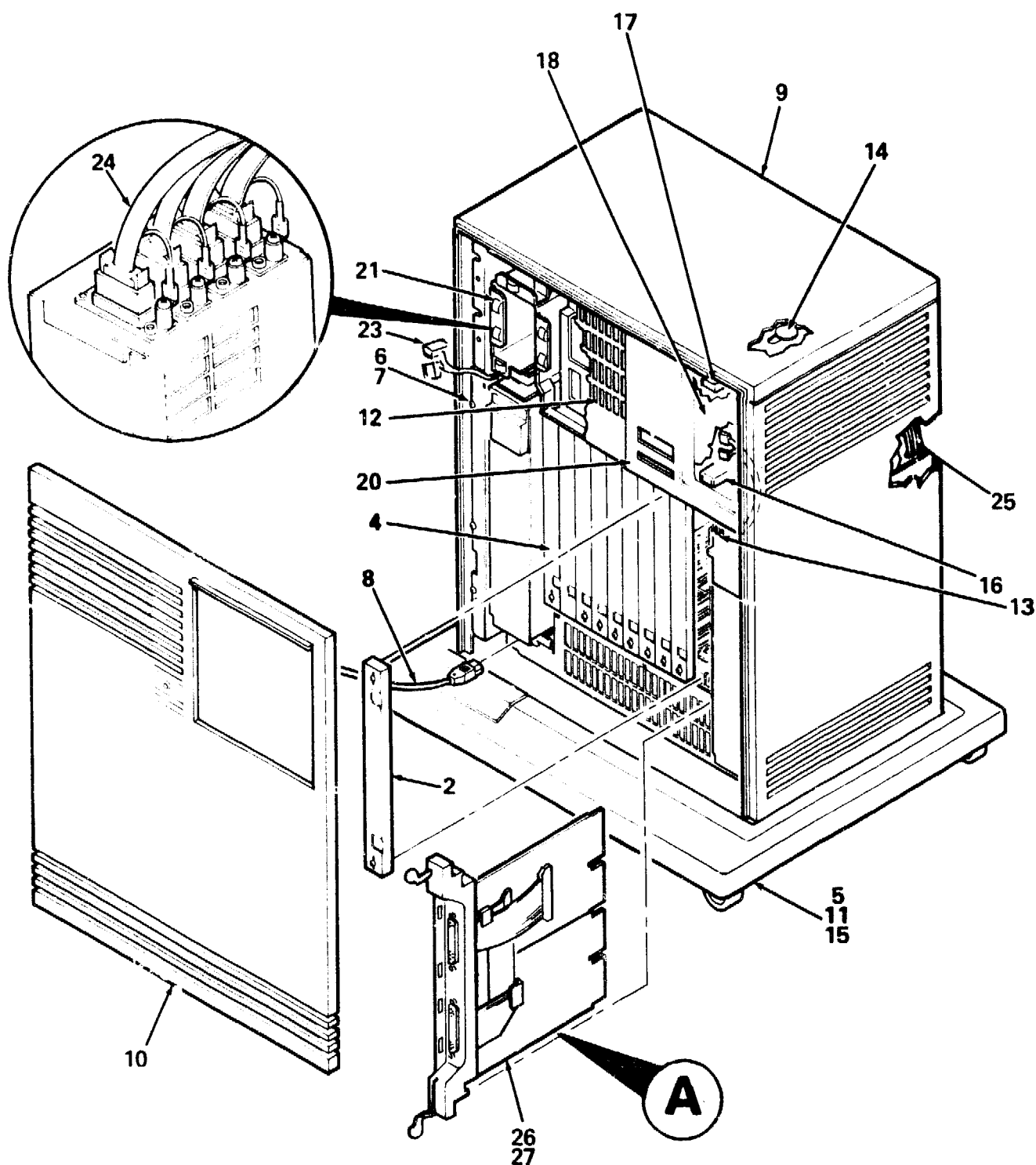

B213A-01A-BD

Figure 1. B213A Expander (Sheet 2 of 3)

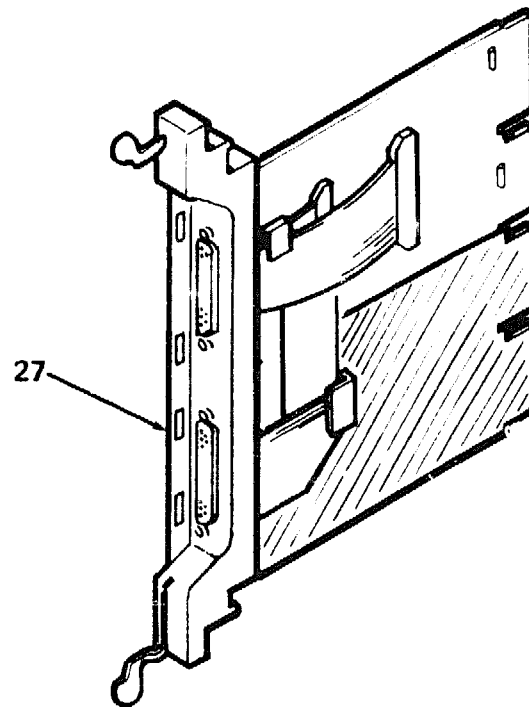
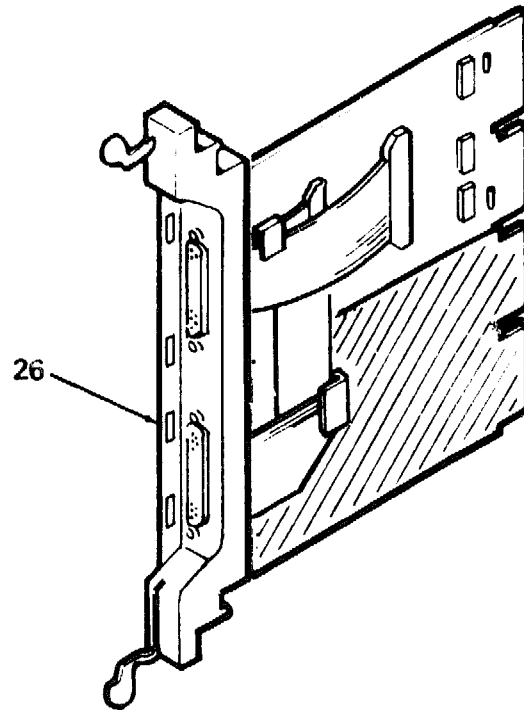

**A**

B213A-01B-BD

**Figure 1. B213A Expander (Sheet 3 of 3)**

FIG. & ITEM NO.	DESCRIPTION	DEC PART NO.	ECO CUT-IN B213A 00000	USED ON CODE	REF FIG NO.
1-	B213A EXPANDER				
	Code A-Used on B213A-A2 2 PS 120V w/o Skins	B213A-A2		A	
	Code B-Used on B213A-A3 2 PS 240V w/o Skins	B213A-A3		B	
	Code C-Used on B213A-B2 2 PS 120V	B213A-B2		C	
	Code D-Used on BA213-B3 2 PS 240V	BA213-B3		D	
1	*ENCLOSURE ASSEMBLY, 2 PS 120V	70-24227-03		AC	1A
	*ENCLOSURE ASSEMBLY, 2 PS 240V	70-24227-04		BD	1A
2	*Bulkhead Assembly, Front	70-23981-01			
3	*Module, Load (Not Shown)	M9060-YA			
4	*Bulkhead Assembly, Front	70-23981-04			
5	*BASE ASSEMBLY	70-24046-01		CD	4
6	*Screw, Self-Tap Phi Pan Hd No. 8-16 x 1/2	90-09800-08			
7	*Washer, Flat	90-06661-00			
8	*Cord, Power 120V	17-00083-43		AC	
	*Cord, Power 240V	17-00365-06		BD	
9	*ENCLOSURE ASSEMBLY, SHELL	70-24037-01		CD	2
10	*PANEL ASSEMBLY, FRONT	70-24041-01		CD	3
11	*Screw, Sems Phi Pan Hd No.10-32 x 5/16	90-09282-00			
12	*Panel Assembly, Front	70-24534-01			
13	*Switch, Frame	74-35417-01		CD	
14	*Plug, Button	90-07064-00		AB	
15	*Fastener, Turn	74-33854-01		CD	
16	*Shock Assembly, Bottom	70-25452-03			
17	*Shock Assembly, Top	70-25452-04			
18	*Panel, 5-1/4" Tape Drive Filler	74-36425-01			
19	*Nameplate, "B213A"	74-34425-36			
20	*OCP Assembly	70-24538-02			
21	*Cable Distribution Assembly	70-24546-03			
22	*Harness Assembly, Wire 4 TWP w/2 Mate-N-Lok Connectors (Right)	17-00362-01			
23	*Harness Assembly, Wire 4 TWP w/2 Mate-N-Lok Connectors (Left)	17-01362-02			
24	*Cable Assembly, 4 Cond Flat	17-01503-01			
25	*Cable Assembly, 10 Cond Flat 2ft	17-01641-01			
26	*Module, Expansion	M9404-PA			
27	*Module, Expansion	M9405-PA			

FIG. & ITEM NO.	DESCRIPTION	DEC PART NO.	ECO CUT-IN B213A 00000	USED ON CODE	REF FIG NO.
1-	KITS (Not Shown)				
	*KIT, ACCESSORIES	70-25807-01		AB	
	**Screwdriver	47-00042-00		AB	
	*KIT, ACCESSORIES	70-25807-02		CD	
	**Screwdriver	47-00042-00		CD	
	**Keys, Front Panel	12-17119-01			
	*Kit, Q-Bus Grant Card Continuity	M9047-SA			
	CABLE (Not Shown)				
	*Cable Assembly, Jumper 7.5ft 10A (This Item Shipped as Loose Piece Part.)	17-00365-06		BD	
	LABELS (Not Shown)				
	*Label, "Warning Equipment Rating 100-120V"	36-17905-16		AC	
	*Label, "Warning Equipment Rating 220-240V"	36-17905-17		BD	
	*Label, "Caution"	36-27924-01			
	*Label, "OCP"	36-28130-03			
	*Label, "M9060-YA Module"	36-26883-17			
	*Label, "Logo Model"	36-27354-26		AB	
	*Label, "Serial Model 100V"	36-27329-01		AC	
	*Label, "Serial Model 220V"	36-27329-03		BD	
	*Label, "Pedestal 100V"	36-27838-01		AC	
	*Label, "Pedestal 220V"	36-27838-37		BD	



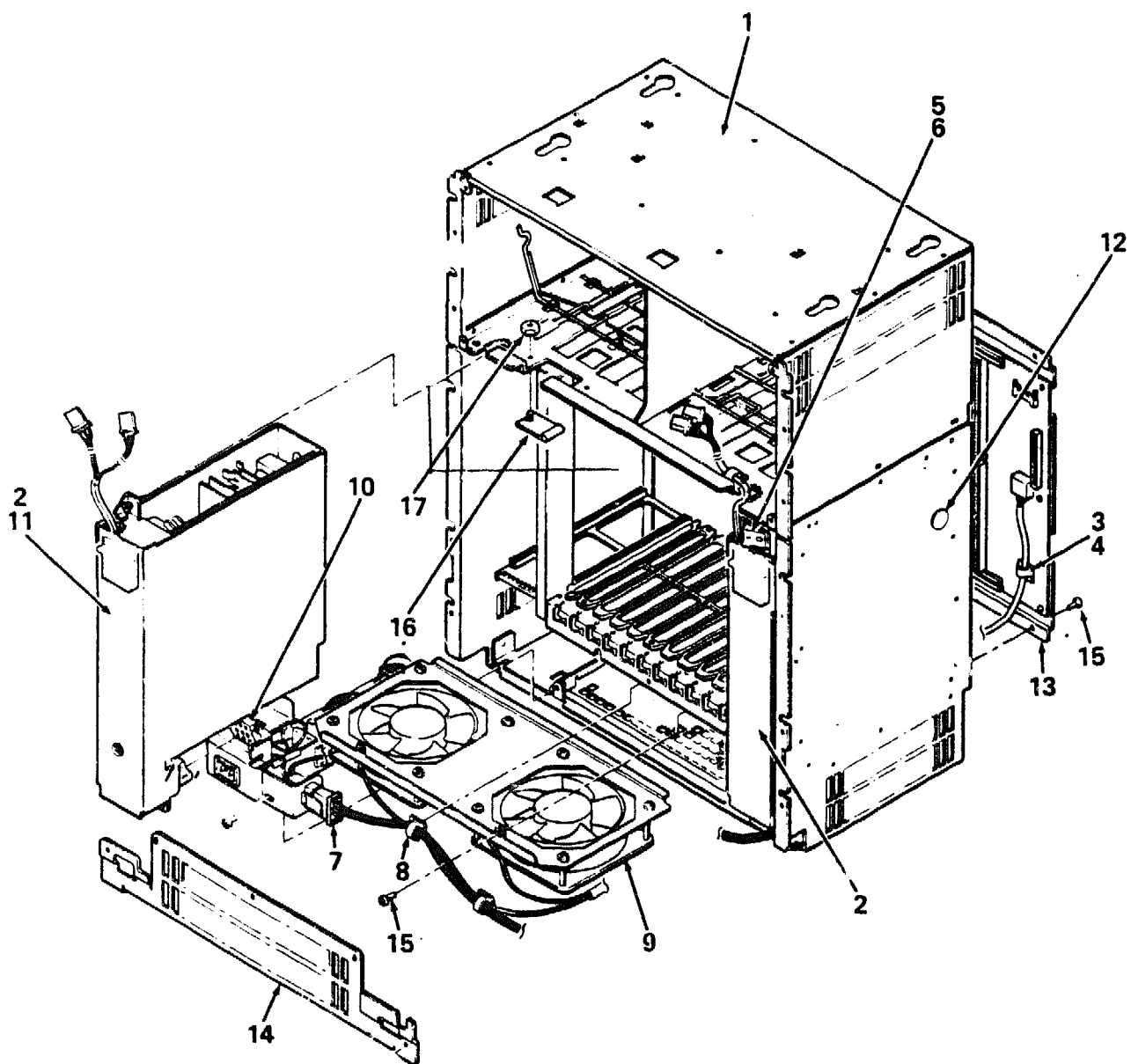

B213A-01C-BD

**Figure 1A. Enclosure Assembly**

FIG. & ITEM NO.	DESCRIPTION	DEC PART NO. <sup>K</sup>	ECO CUT-IN 70-24227 00002	USED ON CODE	REF FIG NO.
1A-	ENCLOSURE ASSEMBLY, BA213 2 PS 120V ENCLOSURE ASSEMBLY, BA213 2 PS 240V	70-24227-03 70-24227-04		AC BD	1 1
1	*Frame Assembly, BA213 (See IPB Manual EK-BA213-IP)	70-24255-01			
2	*Power Supply Assembly, H7868-A 100/120V *Power Supply Assembly, H7868-B 220/240V (See IPB Manual EK-BA213-IP)	H7868-A H7868-B		AC BD	
3	*Clamp, Cable (deleted)	90-08254-00	00007		
4	*Tie, Cable (deleted)	90-07032-00	00007		
5	*Switch Assembly (See IPB Manual EK-BA213-IP)	70-23999-01			
6	*Nut, Kep No. 6-32	90-08185-00			
7	*Cable Assembly	17-01380-01			
8	*Clip, Wire Routing	12-21249-06			
9	*Fan Assembly (See IPB Manual BA213-IP)	70-23998-01			
10	*Input Assembly, Filter (See IPB Manual EK-BA213-IP)	70-23769-01			
11	*Filler, Power Supply Assembly	70-23998-01			
12	*Plug, Button (added)	90-07064-00	00007		
13	*Backplane Assembly, BA213 (See IPB Manual EK-BA213-IP)	70-23712-01			
14	*Panel Assembly, Access	70-25721 01			
15	*Screw, Self Tap Truss Hd No. 6 x 5/16	90-00063-78			
16	*Plate, Cover (added)	74-37040-01	00003		
17	*Nut, Kep No. 6-32 x 1/4 (added)	90-08185-00	00003		

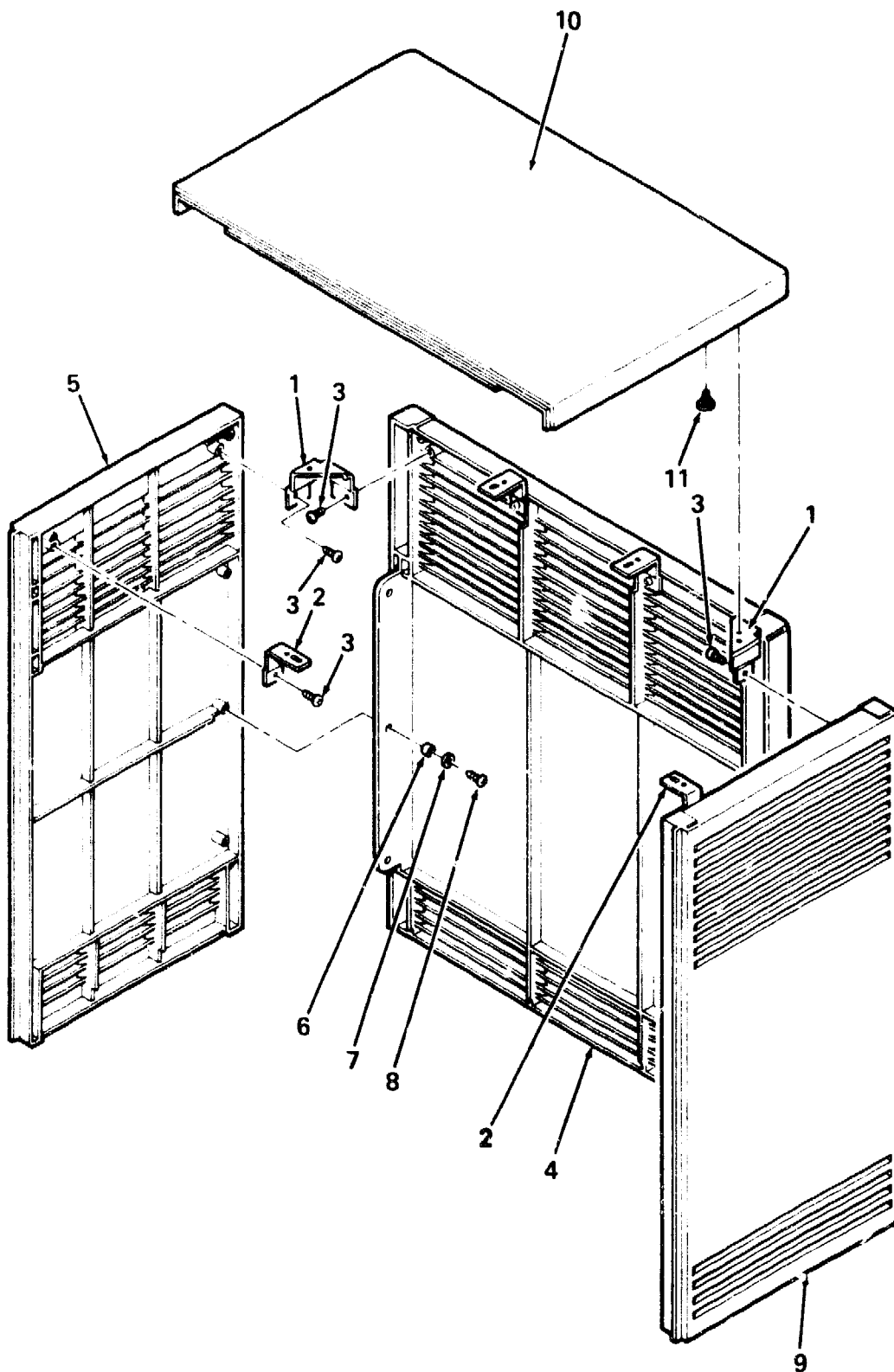

B213A-02-BD

**Figure 2. Enclosure Assembly, Shell**



FIG. & ITEM NO.	DESCRIPTION	DEC PART NO.	E ECO CUT-IN 70-24037 00001	USED ON CODE	REF FIG NO.
2-	ENCLOSURE ASSEMBLY, SHELL	70-24037-01		CD	1
1	*Bracket, Corner	74-34126-01			
2	*Bracket, Side	74-34125-01			
3	*Screw, Self Tap Phl Pan Hd No. 8-16 x 3/8	90-09800-04			
4	*Panel, Rear	74-33651-01			
5	*Panel, Left Side	74-33654-01			
6	*Sleeve	74-34424-01			
7	*Washer, Flat	90-06661-00			
8	*Screw, Self Tap Phl Hd No. 8-16 x 1/2	90-09800-08			
9	*Panel, Right Side	74-33647-01			
10	*Cover, Top	74-33646-01			
11	*Screw, Thread Rolling Shoulder	12-26868-01			

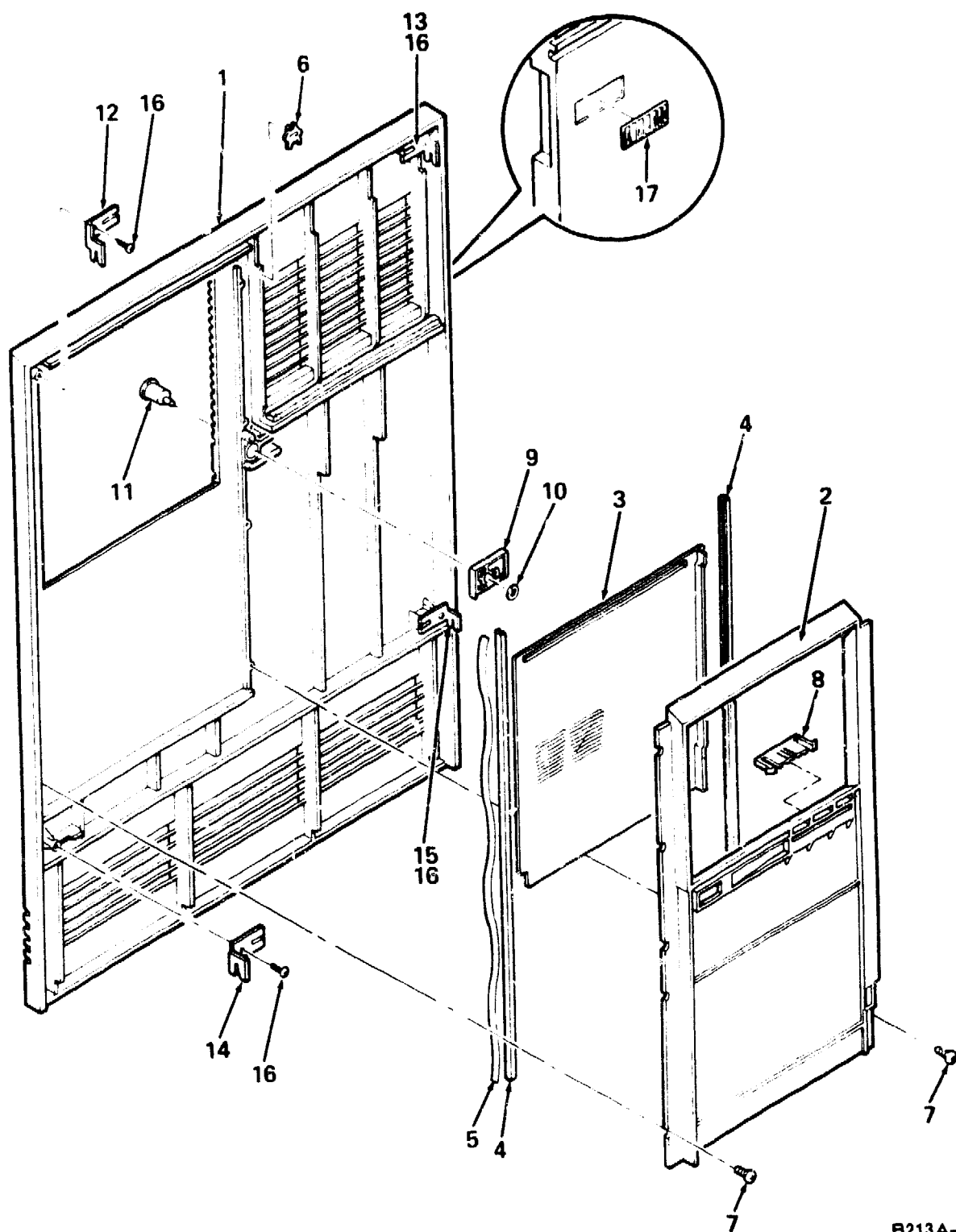

B213A-03-BD

**Figure 3. Panel Assembly, Front**

PARTS LIST

FIG. & ITEM NO.	DESCRIPTION	DEC PART NO.	ECO CUT-IN 70-24041 00000	USED ON CODE	REF FIG NO.
3.	PANEL ASSEMBLY, FRONT	70-24041-01		CD	1
1	*Panel, Front	74-33648-01			
2	*Bezel, Switch	74-34067-01			
3	*Door	74-34061-01			
4	*Channel, Front Panel	74-34062-01			
5	*Spring, Channel	74-34066-01			
6	*Stop, Door Position	74-34363-01			
7	*Screw, Self Tap Phi Pan Hd No. 6-19 x 3/8	90-09800-06			
8	*Latch, Pull	74-34064-01			
9	*Latch, Slide	74-34065-01			
10	*Ring, Retainer	90-09257-05			
11	*Tumbler	74-34063-01			
12	*Bracket, Top Right Hand	74-34123-01			
13	*Bracket, Top Left Hand	74-34123-02			
14	*Bracket, Bottom Right Hand	74-34124-01			
15	*Bracket, Bottom Left Hand	74-34124-02			
16	*Screw, Self Tap Phi Pan Hd No. 8-16 x 3/8	90-09800-04			
17	*Logo	74-34426-01			

FIG. & ITEM NO.	DESCRIPTION	DEC PART NO.	ECO CUT-IN 70-24046 00001	USED ON CODE	REF FIG NO.
4-	BASE ASSEMBLY	70-24046-01		CD	1
1	*Base, Lower	74-33850-01			
2	*Wheel, Base	74-34068-01			
3	*Shaft, Wheel	74-34069-01			
4	*Pin, Roll	90-09385-00			
5	*Screw, Thread Rolling Shoulder	12-26868-01			
6	*Support, Label	74-34846-01			
7	*Screw, Phi Pan Hd Self Tap No. 6-19 x 3/8	90-09800-06			
8	*Fastener, Turn (See Note)	74-33854-01			
9	*Screw, Sems Phi Pan Hd No. 10-32 x 5/16 (See Note)	90-09282-00			
Note : Item part of Figure 1. Shown here for clarity.					

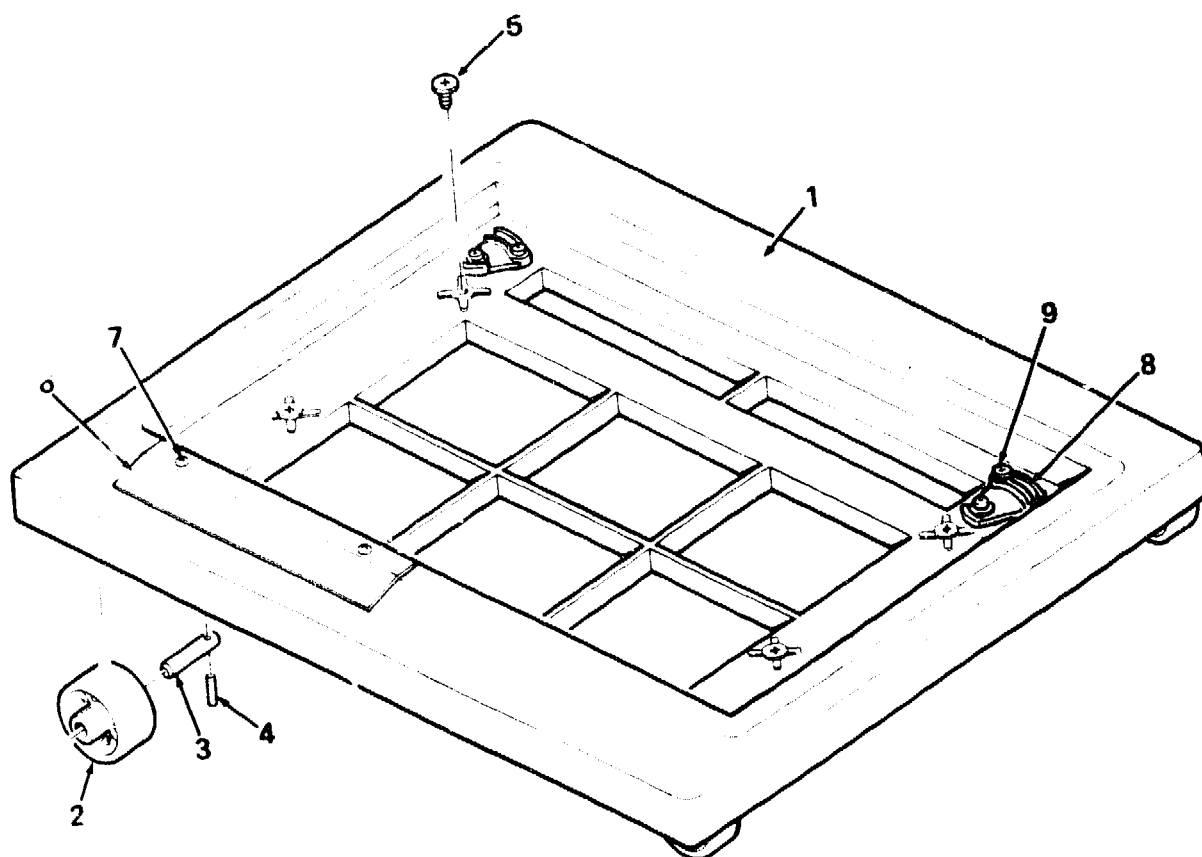

B213A-04-BD

Figure 4. Base Assembly

# **EXPANDER TO HOST CABLE CONNECTIONS**



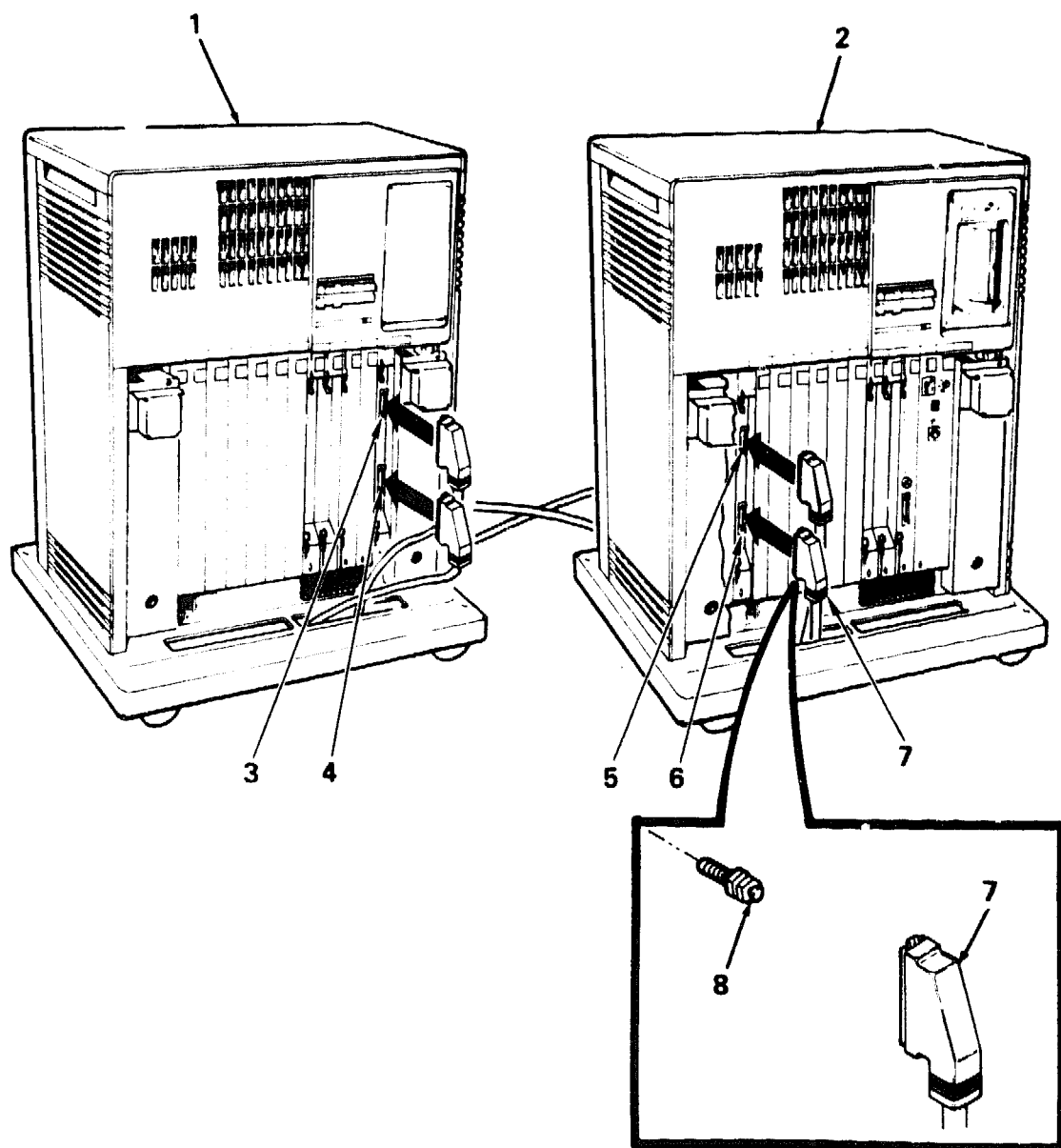

B213A-05-BD

**Figure 5. B213A To MicroVAX 3500 w/Q-Bus Cables**

FIG. & ITEM NO.	DESCRIPTION	DEC PART NO.	ECO CUT-IN	USED ON CODE	REF FIG NO.
5-	B213A TO MicroVAX 3500 w/Q-BUS CABLES				
1	*B213A Expander	B213A			
2	*MicroVAX 3500	MV3500			
3	*Module, Expander (J1 Conn)	M9405-PA			
4	*Module, Expander (J2 Conn)	M9405-PA			
5	*Module, Expander (J2 Conn)	M9404-PA			
6	*Module, Expander (J1 Conn)	M9404-PA			
7	*Cable Assembly, Q-Bus	BC04V-09			
8	*Post Assembly, Locking	12-18672-00			

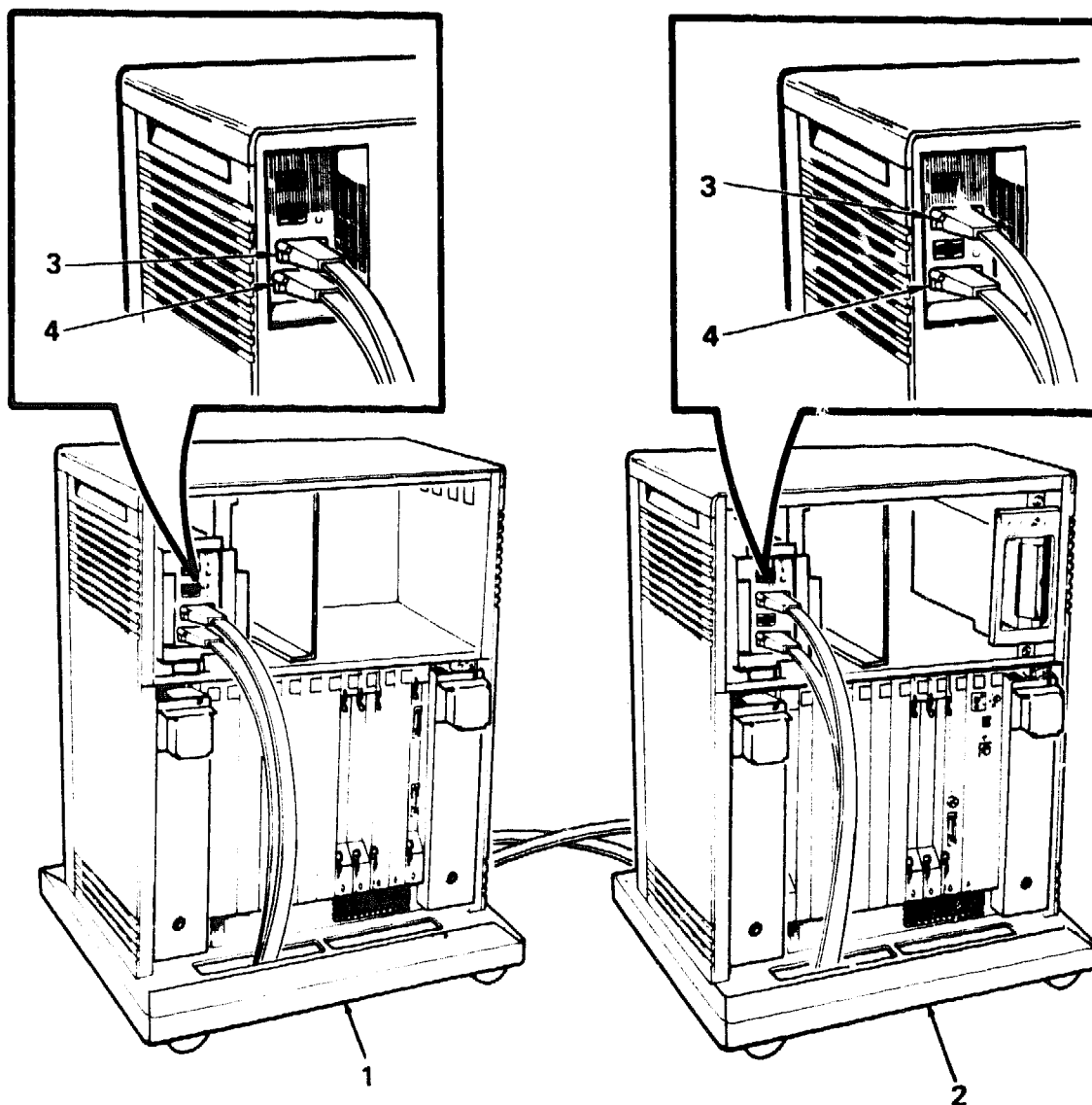

B213A-06-BD

**Figure 6. B213A To MicroVAX 3500 w/SDI Cables**

FIG. & ITEM NO.	DESCRIPTION	DEC PART NO.	ECO CUT-IN	USED ON CODE	REF FIG NO.
6-	B213A TO MicroVAX 3500 w/SDI CABLES				
	1 *B213A Expander	B213A			
	2 *MicroVAX 3500	MV3500			
	3 *Cable Assembly, SDI (Disk 1) (BC26V-12)	17-00464-12			
	4 *Cable Assembly, SDI (Disk 0) (BC26V-12)	17-00464-12			

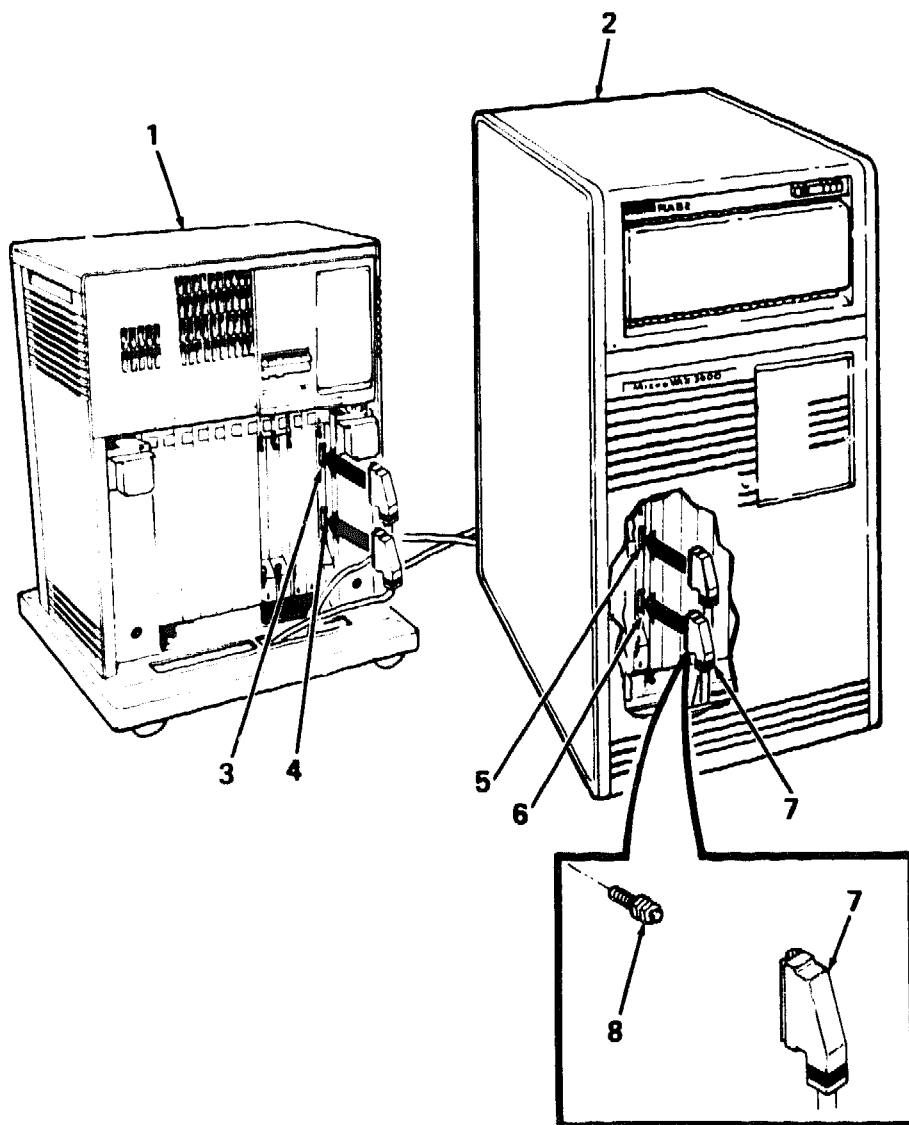

B213A-07-BD

**Figure 7. B213A To MicroVAX 3600/3900 w/Q-Bus**

FIG.& ITEM NO.	DESCRIPTION	DEC PART NO.	ECO CUT-IN	USED ON CODE	REF FIG NO.
7-	B213A TO MicroVAX 3600/3900 w/Q-BUS CABLES				
1	*B213A Expander	B213A			
2	*MicroVAX 3600	MV3600			
	*MicroVAX 3900	MV3900			
3	*Module, Expander (J1 Conn)	M9405-PA			
4	*Module, Expander (J2 Conn)	M9405-PA			
5	*Module, Expander (J2 Conn)	M9404-PA			
6	*Module, Expander (J1 Conn)	M9404-PA			
7	*Cable Assembly, Q-Bus	BC04V-09			
8	*Post Assembly, Locking	12-18672-00			

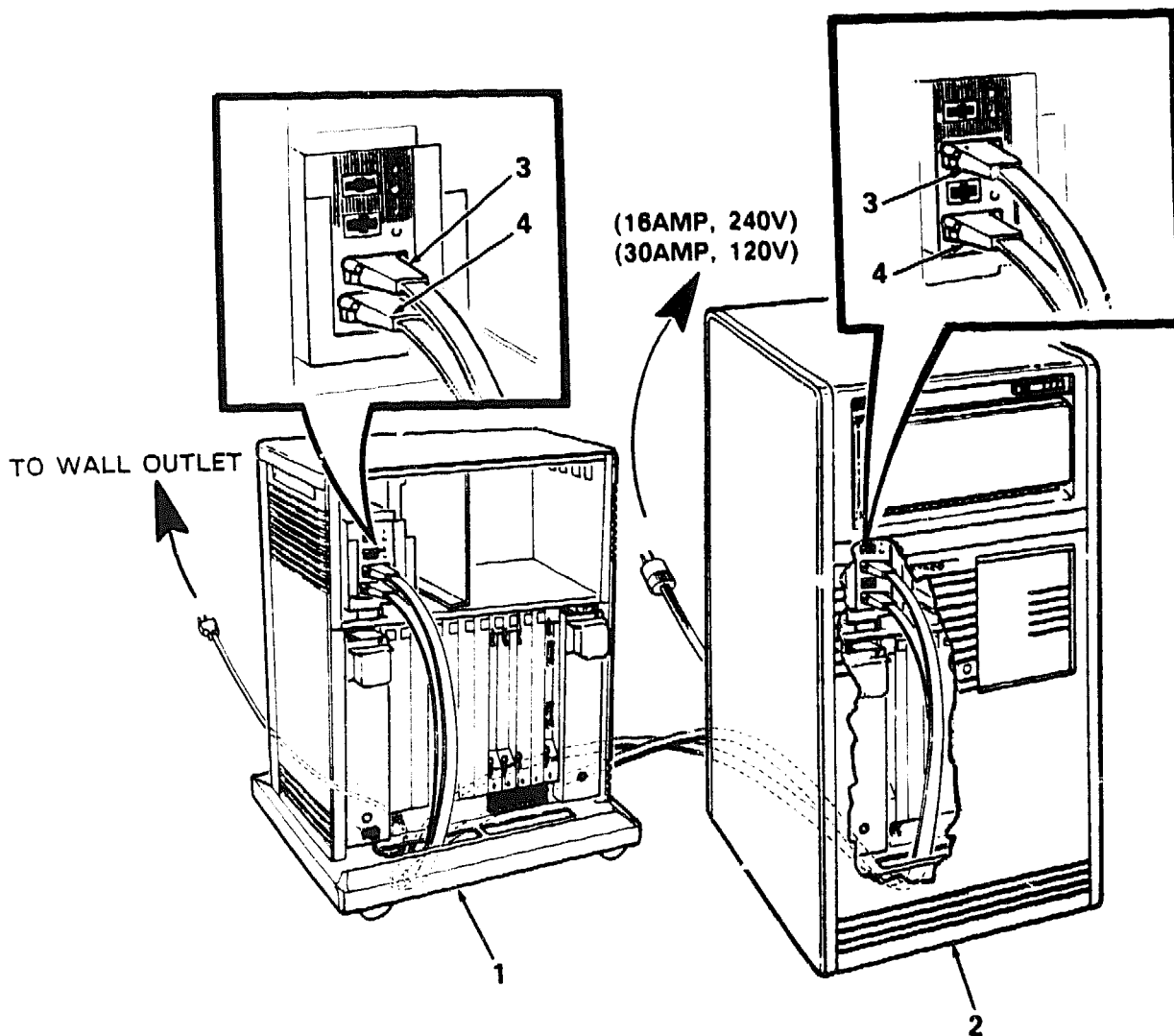

B213A-08-BD

**Figure 8. B213A To MV3600/3900 w/SDI Cables**

FIG.& ITEM NO.	DESCRIPTION	DEC PART NO.	ECO CUT-IN	USED ON CODE	REF FIG NO.
8-	B213A TO MV3600/3900 w/SDI CABLES				
1	*B213A Expander	B213A			
2	*MicroVAX 3600	MV3600			
	*MicroVAX 3900	MV3900			
3	*Cable Assembly, SDI (Disk 1) (BC26V-12)	17-00464-12			
4	*Cable Assembly, SDI (Disk 0) (BC26V-12)	17-00464-12			
	B213A POWER CORDS w/MicroVAX 3600/3900 (Not Shown)				
	**Cord, Power (US) (240V) (BN20A-2E)	17-00083-43		BD	
	**Cord, Power (Japan) (240V) (BN20B-2E)	17-00083-44		BD	
	**Cord, Power (Australia/New Zealand) (240V) (BN20C-2E)	17-00198-04		BD	
	**Cord, Power (Austria, Belgium, (BN20D-2E) Czechoslovakia, France, Finland, Germany, Hungary, Netherlands, Norway, Poland, Portugal, Spain, Sweden, Switzerland) (240V)	17-00199-07		BD	
	**Cord, Power (UK/Ireland) (240V) (BN20E-2E)	17-00209-04		BD	
	**Cord, Power (Switzerland) (240V) (BN20F-2E)	17-00210-04		BD	
	**Cord, Power (Denmark) (240V) (BN20H-2E)	17-00310-07		BD	
	**Cord, Power (Italy) (240V) (BN20J-2E)	17-00364-05		BD	
	**Cord, Power (India/South Africa) (240V) (BN20K-2E)	17-00456-05		BD	
	**Cord, Power (Israel) (240V) (BN20L-2E)	17-00457-05		BD	



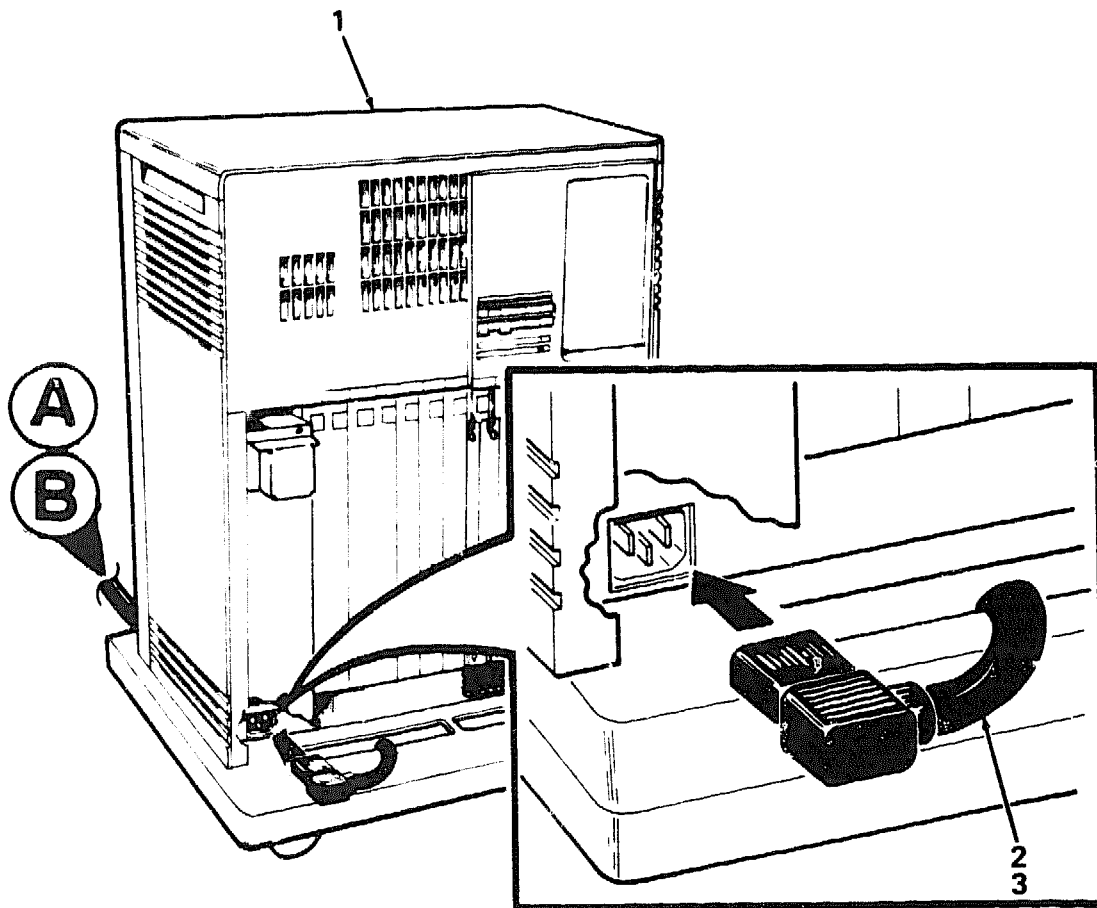

B213A-L -BD

**Figure 9. B213A To MicroVAX 3500 AC Power Connections (Sheet 1 of 3)**

PARTS LIST

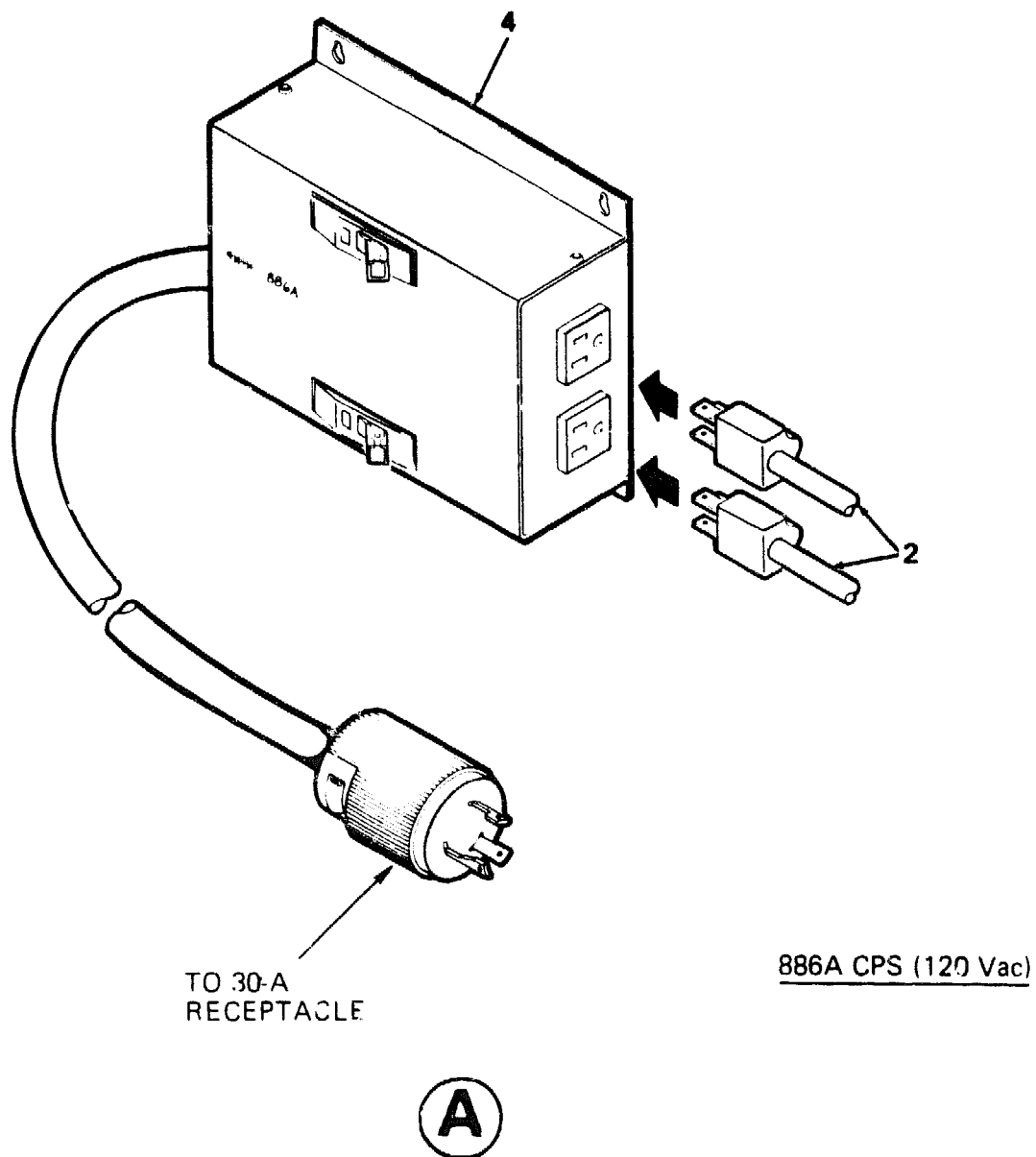

B213A-09A-BD

**Figure 9. B213A To MicroVAX 3500 AC Power Connections (Sheet 2 of 3)**



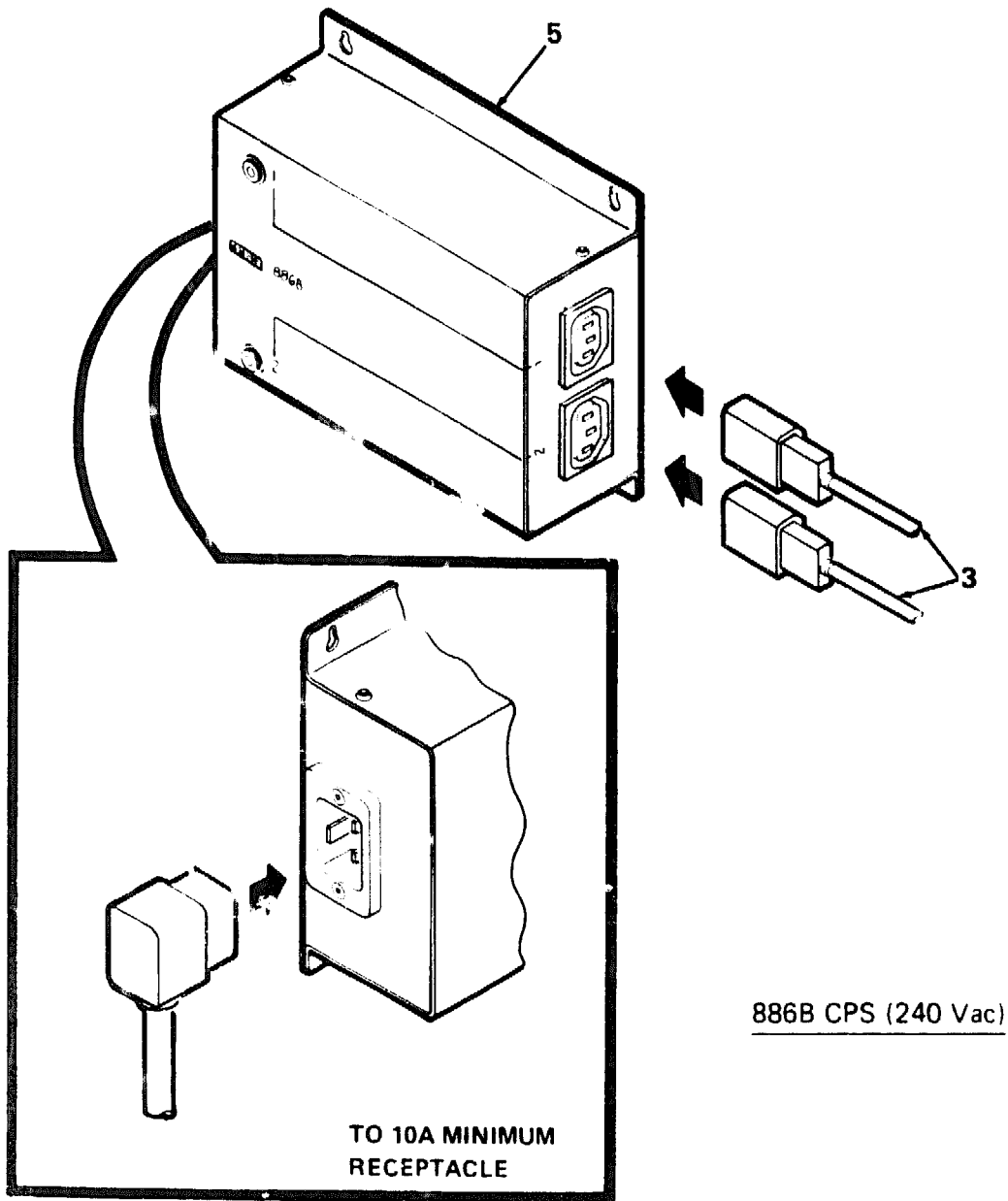

**B**

B213A-09B-BD

**Figure 9. B213A To MicroVAX 3500 AC Power Connections (Sheet 3 of 3)**

PARTS LIST

FIG.& ITEM NO.	DESCRIPTION	DEC PART NO.	ECO CUT-IN	USED ON CODE	REF FIG NO.
9-	B213A TO MicroVAX 3500 AC POWER CONNECTIONS				
1	*B213A Expander	B213A			
2	*Cord, Power (120V) (BN20A-2E)	17-00083-43		AC	
3	*Cord, Power (240V)	17-00365-06		BD	
4	*Switch Assembly, Controlled Power (120V)	30-30166-01		AC	
5	*SWITCH ASSEMBLY, CONTROLLED POWER (240V)	30-30166-02		BD	
	**Cord, Power (UK/Ireland) (240V) (BN18B-4E)	17-00209-05		BD	
	**Cord, Power (Austria, Belgium, France, Finland, Germany, Netherlands, Norway, Portugal, Spain, Sweden, Switzerland) (240V) (BN18C-4E)	17-00199-10		BD	
	**Cord, Power (Australia/New Zealand) (240V) (BN18D-4E)	17-00198-05		BD	
	**Cord, Power (Italy/Switzerland) (240V) (BN18E-4E)	17-00364-06		BD	
	**Cord, Power (Israel) (240V) (BN18F-4E)	17-00457-06		BD	
	**Cord, Power (India) (240V) (BN18H-4E)	17-00456-06		BD	
	**Cord, Power (Denmark) (240V) (BN18P-4E)	17-01255-01		BD	
	**Cord, Power (US/Japan) (240V) (BN18T-4E)	17-00083-37		BD	

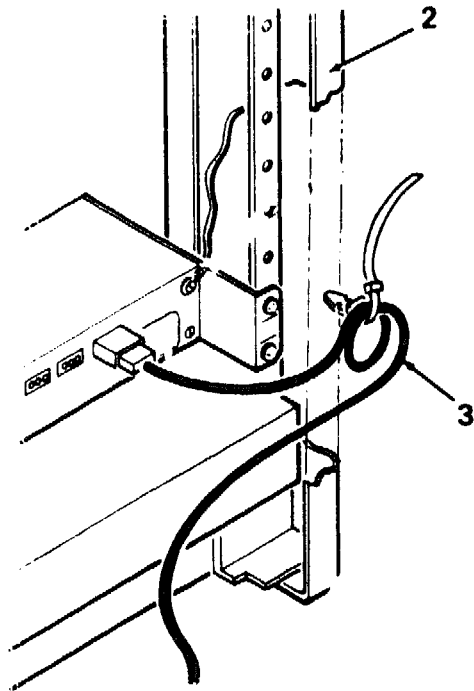

**MicroVAX 3600/3900  
(REAR VIEW)**

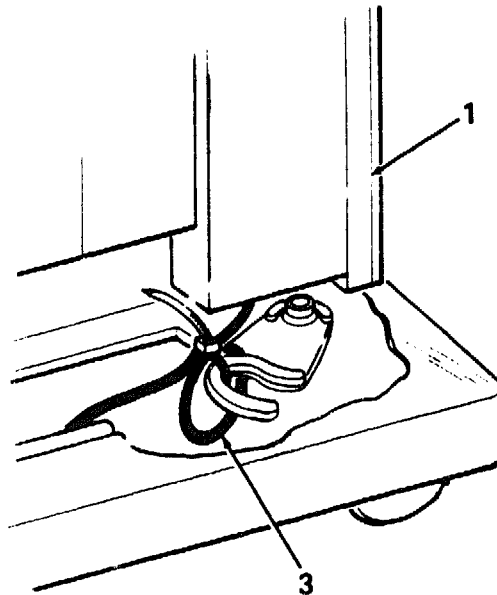

**B213A  
(FRONT VIEW)**

B213A-10-BD

**Figure 10. B213A TO MicroVAX 3600/3900 Power Control Bus Connections**





## **PART NUMBER/DESCRIPTION INDEX**



# **INDEX BY DEC PART NUMBER** **B213A EXPANDER**

<b>PART NO.</b>	<b>DESCRIPTION</b>	<b>FIG NO.</b>	<b>ITEM NO.</b>
12-17119-01	Keys, Front Panel	1	Not Shown
12-18672-00	Post Assembly, Locking	5	8
12-18672-00	Post Assembly, Locking	7	8
12-21249-06	Clip, Wire Routing	1A	8
12-26868-01	Screw, Thread Rolling Shoulder	4	5
12-26868-01	Screw, Thread Rolling Shoulder	2	11
17-00083-37	Cord, Power (US/Japan) (240V) (BN18T-4E)	9	Not Shown
17-00083-43	Cord, Power (US) (240V) (BN20A-2E)	8	Not Shown
17-00083-43	Cord, Power (120V) (BN20A-2E)	9	2
17-00083-43	Cord, Power 120V	1	8
17-00083-44	Cord, Power (Japan) (240V) (BN20B-2E)	8	Not Shown
17-00198-04	Cord, Power (Australia/New Zealand) (240V) (BN20C-2E)	8	Not Shown
17-00198-05	Cord, Power (Australia/New Zealand) (240V) (BN18D-4E)	9	Not Shown
17-00199-07	Cord, Power (Austria, Belgium, Czechoslovakia, France, Finland, Germany, Hungary, Netherlands, Norway, Poland, Portugal, Spain, Sweden, Switzerland) (240V) (BN20D-2E)	8	Not Shown
17-00199-10	Cord, Power (Austria, Belgium, France, Finland, Germany, Netherlands, Norway, Portugal, Spain, Sweden, Switzerland) (240V) (BN18C-4E)	9	Not Shown
17-00209-04	Cord, Power (UK/Ireland) (240V) (BN20E-2E)	8	Not Shown
17-00209-05	Cord, Power (UK/Ireland) (240V) (BN18B-4E)	9	Not Shown
17-00210-04	Cord, Power (Switzerland) (240V) (BN20F-2E)	8	Not Shown
17-00310-07	Cord, Power (Denmark) (240V) (BN20H-2E)	8	Not Shown
17-00362-01	Harness Assembly, Wire 4 TWP w/2 Mate-N-Lok Connectors (Right)	1	22
17-00364-05	Cord, Power (Italy) (240V) (BN20J-2E)	8	Not Shown
17-00364-06	Cord, Power (Italy/Switzerland) (240V) (BN18E-4E)	9	Not Shown
17-00365-06	Cord, Power (240V)	9	3
17-00365-06	Cable Assembly, Jumper 7.5ft 10A	1	Not Shown
17-00365-06	Cord, Power 240V	1	8
17-00456-05	Cord, Power (India/South Africa) (240V) (BN20K-2E)	8	Not Shown
17-00456-06	Cord, Power (India) (240V) (BN18H-4E)	9	Not Shown
17-00457-05	Cord, Power (Israel) (240V) (BN20L-2E)	8	Not Shown
17-00457-06	Cord, Power (Israel) (240V) (BN18F-4E)	9	Not Shown
17-00464-12	Cable Assembly, SDI (Disk 1) (BC26V-12)	8	3
17-00464-12	Cable Assembly, SDI (Disk 1) (BC26V-12)	6	3
17-00464-12	Cable Assembly, SDI (Disk 0) (BC26V-12)	8	4
17-00464-12	Cable Assembly, SDI (Disk 0) (BC26V-12)	6	4
17-01255-01	Cord, Power (Denmark) (240V) (BN18P-4E)	9	Not Shown
17-01360-01	Cable Assembly	14	7
17-01362-02	Harness Assembly, Wire 4 TWP w/2 Mate-N-Lok Connectors (Left)	1	23



**INDEX BY DEC PART NUMBER**  
**B123A EXPANDER**

<b>PART NO.</b>	<b>DESCRIPTION</b>	<b>FIG NO.</b>	<b>ITEM NO.</b>
17-01503-01	Cable Assembly, 4 Cond Flat	1	24
17-01641-01	Cable Assembly, 10 Cond Flat 2ft	1	25
30-30166-01	Switch Assembly, Controlled Power (120V)	9	4
30-30166-02	SWITCH ASSEMBLY, CONTROLLED POWER(240V)	9	5
36-17905-16	Label, "Warning Equipment Rating 100-120V"	1	Not Shown
36-17905-17	Label, "Warning Equipment Rating 220-240V"	1	Not Shown
36-26883-17	Label, "M9080-YA Module"	1	Not Shown
36-27329-01	Label, "Serial Model 100V"	1	Not Shown
36-27329-03	Label, "Serial Model 220V"	1	Not Shown
36-27354-26	Label, "Logo Model"	1	Not Shown
36-27838-01	Label, "Pedestal 100V"	1	Not Shown
36-27838-37	Label, "Pedestal 220V"	1	Not Shown
36-27924-01	Label, "Caution"	1	Not Shown
36-28130-03	Label, "OCP"	1	Not Shown
47-00042-00	Screwdriver	1	Not Shown
70-08288-06	Cable Assembly, Power Control Bus	10	3
70-23712-01	Backplane Assembly, BA213	1A	13
70-23769-01	Input Assembly, Filter	1A	10
70-23981-01	Bulkhead Assembly, Front	1	2
70-23981-04	Bulkhead Assembly, Front	1	4
70-23996-01	Filler, Power Supply Assembly	1A	11
70-23998-01	Fan Assembly	1A	9
70-23999-01	Switch Assembly	1A	5
70-24037-01	ENCLOSURE ASSEMBLY, SHELL	1	9
70-24037-01	ENCLOSURE ASSEMBLY, SHELL	2	N/A
70-24041-01	PANEL ASSEMBLY, FRONT	3	N/A
70-24041-01	PANEL ASSEMBLY, FRONT	1	10
70-24046-01	BASE ASSEMBLY	4	N/A
70-24046-01	BASE ASSEMBLY	1	5
70-24227-03	ENCLOSURE ASSEMBLY, 2 PS 120V	1	1
70-24227-03	ENCLOSURE ASSEMBLY, 2 PS 120V	1A	N/A
70-24227-04	ENCLOSURE ASSEMBLY, 2 PS 240V	1	1
70-24227-04	ENCLOSURE ASSEMBLY, 2 PS 240V	1A	N/A
70-24255-01	Frame Assembly, BA213	1A	1
70-24534-01	Panel Assembly, Front	1	12
70-24538-02	OCP Assembly	1	20
70-24546-03	Cable Distribution Assembly	1	21
70-25452-03	Shock Assembly, Bottom	1	16
70-25452-04	Shock Assembly, Top	1	17
70-25721-01	Panel Assembly, Access	1A	14
70-25807-01	KIT, ACCESSORIES	1	Not Shown
70-25807-02	KIT, ACCESSORIES	1	Not Shown
74-33646-01	Cover, Top	2	10
74-33647-01	Panel, Right Side	2	9
74-33648-01	Panel, Front	3	1
74-33650-01	Base, Lower	4	1
74-33651-01	Panel, Rear	2	4

# **INDEX BY DEC PART NUMBER** **B123A EXPANDER**

<b>PART NO.</b>	<b>DESCRIPTION</b>	<b>FIG NO.</b>	<b>ITEM NO.</b>
74-33894-01	Panel, Left Side	2	5
74-33854-01	Fastener, Turn	4	8
74-33854-01	Fastener, Turn	1	15
74-34061-01	Door	3	3
74-34062-01	Channel, Front Panel	3	4
74-34063-01	Tumbler	3	11
74-34064-01	Latch, Pull	3	8
74-34065-01	Latch, Slide	3	9
74-34066-01	Spring, Channel	3	5
74-34067-01	Bezel, Switch	3	2
74-34068-01	Wheel, Base	4	2
74-34069-01	Shaft, Wheel	4	3
74-34123-01	Bracket, Top Right Hand	3	12
74-34123-02	Bracket, Top Left Hand	3	13
74-34124-01	Bracket, Bottom Right Hand	3	14
74-34124-02	Bracket, Bottom Left Hand	3	15
74-34125-01	Bracket, Side	2	2
74-34126-01	Bracket, Corner	2	1
74-34363-01	Stop, Door Position	3	6
74-34424-01	Sleeve	2	6
74-34425-36	Nameplate, "B213A"	1	19
74-34426-01	Logo	3	17
74-34846-01	Support, Label	4	6
74-35417-01	Switch, Frame	1	13
74-36425-01	Panel, 5-1/4" Tape Drive Filler	1	18
74-37040-01	Plate, Cover (added)	1A	16
90-00063-78	Screw, Self Tap Truss Hd No. 6 x 5/16	1A	15
90-06661-00	Washer, Flat	1	7
90-06661-00	Washer, Flat	2	7
90-07032-00	Tie, Cable (deleted)	1A	4
90-07064-00	Plug, Button (added)	1A	12
90-07064-00	Plug, Button	1	14
90-08185-00	Nut, Kep No. 6-32	1A	6
90-08185-00	Nut, Kep No. 6-32 x 1/4 (added)	1A	17
90-08264-00	Clamp, Cable (deleted)	1A	3
90-09257-05	Ring, Retainer	3	10
90-09282-00	Screw, Sems Phi Pan Hd No. 10-32 x 5/16	4	9
90-09282-00	Screw, Sems Phi Pan Hd No. 10-32 x 5/16	1	11
90-09385-00	Pin, Roll	4	4
90-09800-04	Screw, Self-Tap Phi Pan Hd No. 8-16 x 3/8	2	3
90-09800-04	Screw, Self-Tap Phi Pan Hd No. 8-16 x 3/8	3	16
90-09800-06	Screw, Self-Tap Phi Pan Hd No. 6-19 x 3/8	3	7
90-09800-06	Screw, Self-Tap Phi Pan Hd No. 6-19 x 3/8	4	7
90-09800-08	Screw, Self-Tap Phi Pan Hd No. 8-16 x 1/2	2	8
90-09800-08	Screw, Self-Tap Phi Pan Hd No. 8-16 x 1/2	1	6
B213A	B213A Expander	5	1
B213A	B213A Expander	6	1
B213A	B213A Expander	9	1
B213A	B213A Expander	7	1

**INDEX BY DEC PART NUMBER  
B123A EXPANDER**

<b>PART NO.</b>	<b>DESCRIPTION</b>	<b>FIG NO.</b>	<b>ITEM NO.</b>
B213A	B213A Expander	8	1
B213A	B213A Expander	10	1
B213A-A2	B213A-A2 2 PS 120V w/o Skins	1	N/A
B213A-A3	B213A-A3 2 PS 240V w/o Skins	1	N/A
B213A-B2	B213A-B2 2 PS 120V	1	N/A
BA213-B3	BA213-B3 2 PS 240V	1	N/A
BC04V-09	Cable Assembly, Q-Bus	5	7
BC04V-09	Cable Assembly, Q-Bus	7	7
H7868-A	Power Supply Assembly, H7868-A 100/120V	1A	2
H7868-B	Power Supply Assembly, H7868-B 220/240V	1A	2
M9047-SA	Kit, Q-Bus Grant Card Continuity	1	Not Shown
M9060-YA	Module, Load (Not Shown)	1	3
M9404-PA	Module, Expander (J1 Conn)	7	6
M9404-PA	Module, Expander (J1 Conn)	5	6
M9404-PA	Module, Expansion	1	26
M9404-PA	Module, Expander (J2 Conn)	5	5
M9404-PA	Module, Expander (J2 Conn)	7	5
M9405-PA	Module, Expander (J2 Conn)	7	4
M9405-PA	Module, Expander (J1 Conn)	5	3
M9405-PA	Module, Expander (J2 Conn)	5	4
M9405-PA	Module, Expander (J1 Conn)	7	3
M9405-PA	Module, Expansion	1	27
MV3500	MicroVAX 3500	6	2
MV3500	MicroVAX 3500	5	2
MV3600	MicroVAX 3600	8	2
MV3600	MicroVAX 3600	7	2
MV3600	MicroVAX 3600	10	2
MV3900	MicroVAX 3900	7	2
MV3900	MicroVAX 3900	8	2
MV3900	MicroVAX 3900	10	2
N/A	B213A TO MicroVAX 3500 w/SDI CABLES	6	N/A
N/A	B213A TO MicroVAX 3500 AC POWER CONNECTIONS	9	N/A
N/A	B213A EXPANDER	1	N/A
N/A	B213A TO MicroVAX 3600/3900 w/Q-BUS CABLES	7	N/A
N/A	B213A TO MicroVAX 3500 w/Q-BUS CABLES	5	N/A
N/A	B213A TO MicroVAX 3600/3900 POWER CONTROL BUS CONNECTION	10	N/A
N/A	B213A TO MV3600/3900 w/SDI CABLES	8	N/A

**INDEX BY DEC PART DESCRIPTION  
B213A EXPANDER**

<b>DESCRIPTION</b>	<b>DEC PART NO.</b>	<b>FIG. NO.</b>	<b>ITEM NO.</b>
B213A EXPANDER	N/A	1	N/A
B213A Expander	B213A	7	1
B213A Expander	B213A	5	1
B213A Expander	B213A	9	1
B213A Expander	B213A	6	1
B213A Expander	B213A	8	1
B213A Expander	B213A	10	1
B213A TO MicroVAX 3500 AC POWER CONNECTIONS	N/A	9	N/A
B213A TO MicroVAX 3500 w/Q-BUS CABLES	N/A	5	N/A
B213A TO MicroVAX 3500 w/SDI CABLES	N/A	6	N/A
B213A TO MicroVAX 3600/3900 POWER CONTROL	N/A	10	N/A
BUS CONNECTIONB213A TO MicroVAX 3600/3900 w/Q-BUS CABLES	N/A	7	N/A
B213A TO MV3600/3900 w/SDI CABLES	N/A	8	N/A
B213A-A2 2 PS 120V w/o Skins	B213A-A2	1	N/A
B213A-A3 2 PS 240V w/o Skins	B213A-A3	1	N/A
B213A-B2 2 PS 120V	B213A-B2	1	N/A
BA213-B3 2 PS 240V	BA213-B3	1	N/A
Backplane Assembly, BA213	70-23712-01	1A	13
BASE ASSEMBLY	70-24046-01	1	5
BASE ASSEMBLY	70-24046-01	4	N/A
Base, Lower	74-33650-01	4	1
Bezel, Switch	74-34067-01	3	2
Bracket, Bottom Left Hand	74-34124-02	3	15
Bracket, Bottom Right Hand	74-34124-01	3	14
Bracket, Corner	74-34126-01	2	1
Bracket, Side	74-34125-01	2	2
Bracket, Top Left Hand	74-34123-02	3	13
Bracket, Top Right Hand	74-34123-01	3	12
Bulkhead Assembly, Front	70-23981-01	1	2
Bulkhead Assembly, Front	70-23981-04	1	4
Cable Assembly	17-01360-01	1A	7
Cable Assembly, 10 Cond Flat 2ft	17-01641-01	1	25
Cable Assembly, 4 Cond Flat	17-01503-01	1	24
Cable Assembly, Jumper 7.5ft 10A	17-00365-06	1	Not Shown
Cable Assembly, Power Control Bus	70-08288-06	10	3
Cable Assembly, Q-Bus	BC04V-09	5	7
Cable Assembly, Q-Bus	BC04V-09	7	7
Cable Assembly, SDI (Disk 0) (BC26V-12)	17-00464-12	6	4
Cable Assembly, SDI (Disk 0) (BC26V-12)	17-00464-12	8	4
Cable Assembly, SDI (Disk 1) (BC26V-12)	17-00464-12	6	3
Cable Assembly, SDI (Disk 1) (BC26V-12)	17-00464-12	8	3
Cable Distribution Assembly	70-24546-03	1	21
Channel, Front Panel	74-34062-01	3	4
Clamp, Cable (deleted)	90-08264-00	1A	3
Clip, Wire Routing	12-21249-06	1A	8
Cord, Power (120V) (BN20A-2E)	17-00083-43	9	2
Cord, Power (240V)	17-00365-06	9	3
Cord, Power (Australia/New Zealand) (240V) (BN18D-4E)	17-00198-05	9	Not Shown

**INDEX BY DEC PART DESCRIPTION  
B213A EXPANDER**

<b>DESCRIPTION</b>	<b>DEC PART NO.</b>	<b>FIG. NO.</b>	<b>ITEM NO.</b>
Cord, Power (Australia/New Zealand) (240V) (BN20C-2E)	17-00198-04	8	Not Shown
Cord, Power (Austria, Belgium, Czechoslovakia, France, Finland, Germany, Hungary, Netherlands, Norway, Poland, Portugal, Spain, Sweden, Switzerland) (240V) (BN20D-2E)	17-00199-07	8	Not Shown
Cord, Power (Austria, Belgium, France, Finland, Germany, Netherlands, Norway, Portugal, Spain, Sweden, Switzerland) (240V) (BN18C-4E)	17-00199-10	9	Not Shown
Cord, Power (Denmark) (240V) (BN18P-4E)	17-01255-01	9	Not Shown
Cord, Power (Denmark) (240V) (BN20H-2E)	17-00310-07	8	Not Shown
Cord, Power (India) (240V) (BN18H-4E)	17-00456-06	9	Not Shown
Cord, Power (India/South Africa) (240V) (BN20K-2E)	17-00456-05	8	Not Shown
Cord, Power (Israel) (240V) (BN18F-4E)	17-00457-06	9	Not Shown
Cord, Power (Israel) (240V) (BN20L-2E)	17-00457-05	8	Not Shown
Cord, Power (Italy) (240V) (BN20J-2E)	17-00364-05	8	Not Shown
Cord, Power (Italy/Switzerland) (240V) (BN18E-4E)	17-00364-06	9	Not Shown
Cord, Power (Japan) (240V) (BN20B-2E)	17-00083-44	8	Not Shown
Cord, Power (Switzerland) (240V) (BN20F-2E)	17-00210-04	8	Not Shown
Cord, Power (UK/Ireland) (240V) (BN18B-4E)	17-00209-05	9	Not Shown
Cord, Power (UK/Ireland) (240V) (BN20E-2E)	17-00209-04	8	Not Shown
Cord, Power (US) (240V) (BN20A-2E)	17-00083-43	8	Not Shown
Cord, Power (US/Japan) (240V) (BN18T-4E)	17-00083-37	9	Not Shown
Cord, Power 120V	17-00083-43	1	8
Cord, Power 240V	17-00365-06	1	8
Cover, Top	74-33646-01	2	10
Door	74-34061-01	3	3
ENCLOSURE ASSEMBLY, 2 PS 120V	70-24227-03	1	1
ENCLOSURE ASSEMBLY, 2 PS 240V	70-24227-04	1	1
ENCLOSURE ASSEMBLY, BA213 2 PS 120V	70-24227-03	1A	N/A
ENCLOSURE ASSEMBLY, BA213 2 PS 240V	70-24227-04	1A	N/A
ENCLOSURE ASSEMBLY, SHELL	70-24037-01	1	9
ENCLOSURE ASSEMBLY, SHELL	70-24037-01	2	N/A
Fan Assembly	70-23998-01	1A	9
Fastener, Turn	74-33854-01	1	15
Fastener, Turn	74-33854-01	4	8
Filler, Power Supply Assembly	70-23996-01	1A	11
Frame Assembly, BA213	70-24255-01	1A	1
Harness Assembly, Wire 4 TWP w/2 Mate-N-Lok Connectors (Left)	17-01362-02	1	23
Harness Assembly, Wire 4 TWP w/2 Mate-N-Lok Connectors (Right)	17-00362-01	1	22
Input Assembly, Filter	70-23769-01	1A	10

**INDEX BY DEC PART DESCRIPTION  
B213A EXPANDER**

<b>DESCRIPTION</b>	<b>DEC PART NO.</b>	<b>FIG. NO.</b>	<b>ITEM NO.</b>
Keys, Front Panel	12-17119-01	1	Not Shown
Kit, Q-Bus Grant Card Continuity	M9047-SA	1	Not Shown
KIT, ACCESSORIES	70-25807-01	1	Not Shown
KIT, ACCESSORIES	70-25807-02	1	Not Shown
Label, "Caution"	36-27924-01	1	Not Shown
Label, "Logo Model"	36-27354-26	1	Not Shown
Label, "M9060-YA Module"	36-26883-17	1	Not Shown
Label, "OCP"	36-28130-03	1	Not Shown
Label, "Pedestal 100V"	36-27838-01	1	Not Shown
Label, "Pedestal 220V"	36-27838-37	1	Not Shown
Label, "Serial Model 100V"	36-27329-01	1	Not Shown
Label, "Serial Model 220V"	36-27329-03	1	Not Shown
Label, "Warning Equipment Rating 100-120V"	36-17905-16	1	Not Shown
Label, "Warning Equipment Rating 220-240V"	36-17905-17	1	Not Shown
Latch, Pull	74-34064-01	3	8
Latch, Slide	74-34065-01	3	9
Logo	74-34426-01	3	17
MicroVAX 3500	MV3500	5	2
MicroVAX 3500	MV3500	6	2
MicroVAX 3600	MV3600	7	2
MicroVAX 3600	MV3600	10	2
MicroVAX 3600	MV3600	8	2
MicroVAX 3900	MV3900	8	2
MicroVAX 3900	MV3900	7	2
MicroVAX 3900	MV3900	10	2
Module, Expander (J1 Conn)	M9404-PA	5	6
Module, Expander (J1 Conn)	M9405-PA	7	3
Module, Expander (J1 Conn)	M9405-PA	5	3
Module, Expander (J1 Conn)	M9404-PA	7	6
Module, Expander (J2 Conn)	M9404-PA	5	5
Module, Expander (J2 Conn)	M9405-PA	7	4
Module, Expander (J2 Conn)	M9404-PA	7	5
Module, Expander (J2 Conn)	M9405-PA	5	4
Module, Expansion	M9404-PA	1	26
Module, Expansion	M9405-PA	1	27
Module, Load (Not Shown)	M9060-YA	1	3
Nameplate, "B213A"	74-34425-36	1	19
Nut, Kep No. 6-32	90-08185-00	1A	6
Nut, Kep No. 6-32 x 1/4 (added)	90-08185-00	1A	17
OCP Assembly	70-24538-02	1	20

**INDEX BY DEC PART DESCRIPTION  
B213A EXPANDER**

DESCRIPTION	DEC PART NO.	FIG. NO.	ITEM NO.
Panel Assembly, Access	70-25721-01	1A	14
PANEL ASSEMBLY, FRONT	70-24041-01	3	N/A
Panel Assembly, Front	70-24534-01	1	12
PANEL ASSEMBLY, FRONT	70-24041-01	1	10
Panel, 5-1/4" Tape Drive Filler	74-36425-01	1	18
Panel, Front	74-33648-01	3	1
Panel, Left Side	74-33694-01	2	5
Panel, Rear	74-33651-01	2	4
Panel, Right Side	74-33647-01	2	9
Pin, Roll	90-09385-00	4	4
Plate, Cover (added)	74-37040-01	1A	16
Plug, Button	90-07084-00	1	14
Plug, Button (added)	90-07084-00	1A	12
Post Assembly, Locking	12-18672-00	5	8
Post Assembly, Locking	12-18672-00	7	8
Power Supply Assembly, H7868-A 100/120V	H7868-A	1A	2
Power Supply Assembly, H7868-B 220/240V	H7868-B	1A	2
Ring, Retainer	90-09257-05	3	10
Screw, Self-Tap Phi Pan Hd No. 6-19 x 3/8	90-09800-06	4	7
Screw, Self-Tap Phi Pan Hd No. 8-16 x 1/2	90-09800-08	2	8
Screw, Self-Tap Phi Pan Hd No. 8-16 x 3/8	90-09800-04	2	3
Screw, Self-Tap Phi Pan Hd No. 6-19 x 3/8	90-09800-06	3	7
Screw, Self-Tap Phi Pan Hd No. 8-16 x 3/8	90-09800-04	3	16
Screw, Self-Tap Truss Hd No. 6 x 5/16	90-00063-78	1A	15
Screw, Self-Tap Phi Pan Hd No. 8-16 x 1/2	90-09800-08	1	6
Screw, Sems Phi Pan Hd No. 10-32 x 5/16	90-09282-00	4	9
Screw, Sems Phi Pan Hd No. 10-32 x 5/16	90-09282-00	1	11
Screw, Thread Rolling Shoulder	12-26868-01	4	5
Screw, Thread Rolling Shoulder	12-26868-01	2	11
Screwdriver	47-00042-00	1	Not Shown
Shaft, Wheel	74-34069-01	4	3
Shock Assembly, Bottom	70-25452-03	1	16
Shock Assembly, Top	70-25452-04	1	17
Sleeve	74-34424-01	2	6
Spring, Channel	74-34068-01	3	5
Stop, Door Position	74-34363-01	3	6
Support, Label	74-34846-01	4	6
Switch Assembly	70-23999-01	1A	5
Switch Assembly, Controlled Power (120V)	30-30166-01	9	4
SWITCH ASSEMBLY, CONTROLLED POWER (240V)	30-30166-02	9	5
Switch, Frame	74-35417-01	1	13
Tie, Cable (deleted)	90-07032-00	1A	4
Tumbler	74-34063-01	3	11
Washer, Flat	90-06661-00	2	7
Washer, Flat	90-06661-00	1	7
Wheel, Base	74-34068-01	4	2